

# 1717 DUBLIN AVE

WINNIPEG, MB

FOR LEASE: INDUSTRIAL



STARTING FROM:  
**\$7.95** PER SF

## Warehouse/Office Space Available

### PROPERTY HIGHLIGHTS

- Conveniently located in Winnipeg's St. James Industrial Park
- In close proximity to major trucking routes and James Armstrong Richardson International Airport
- Comprised of approximately 3,572 SF of office/showroom space and 2,000 SF of warehouse

#### BRAD GOERZEN

Senior Vice President—Leasing—Central Region

(+1) 204-934-2797

bgoerzen@artisreit.com



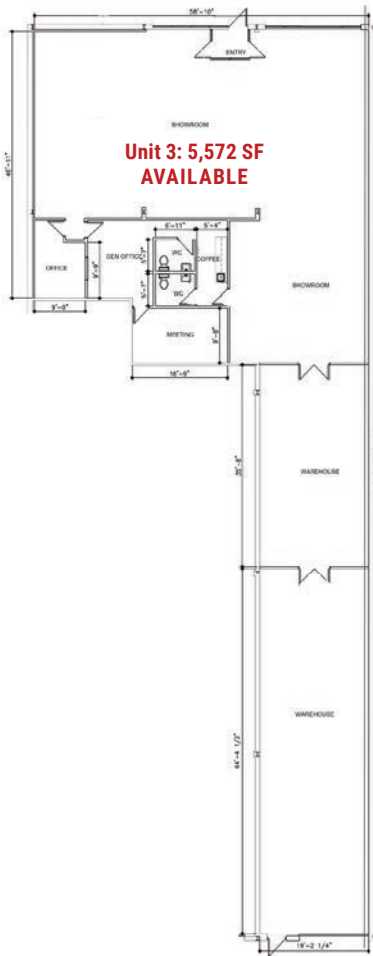

**BRAD GOERZEN**  
 Senior Vice President—Leasing—Central Region  
 (+1) 204-934-2797  
 bgoerzen@artisreit.com

**1717 DUBLIN AVENUE, WINNIPEG, MB**





## PROPERTY DETAILS

Asking Net Rent	\$7.95/SF
Additional Rent	\$4.79/SF (\$2.87 CAM, \$1.92 Tax est. 2022) + 5% mgmt fee on gross rent
Size	Office/Showroom: 3,572 SF Warehouse: 2,000 SF <b>Total: 5,572 SF</b>
Ceiling Height	14' Clear
Loading	Grade Level Loading
Zoning	M2
Available	Immediately

### BRAD GOERZEN

Senior Vice President—Leasing—Central Region

(+1) 204-934-2797

bgoerzen@artisreit.com

**1717 DUBLIN AVENUE, WINNIPEG, MB**

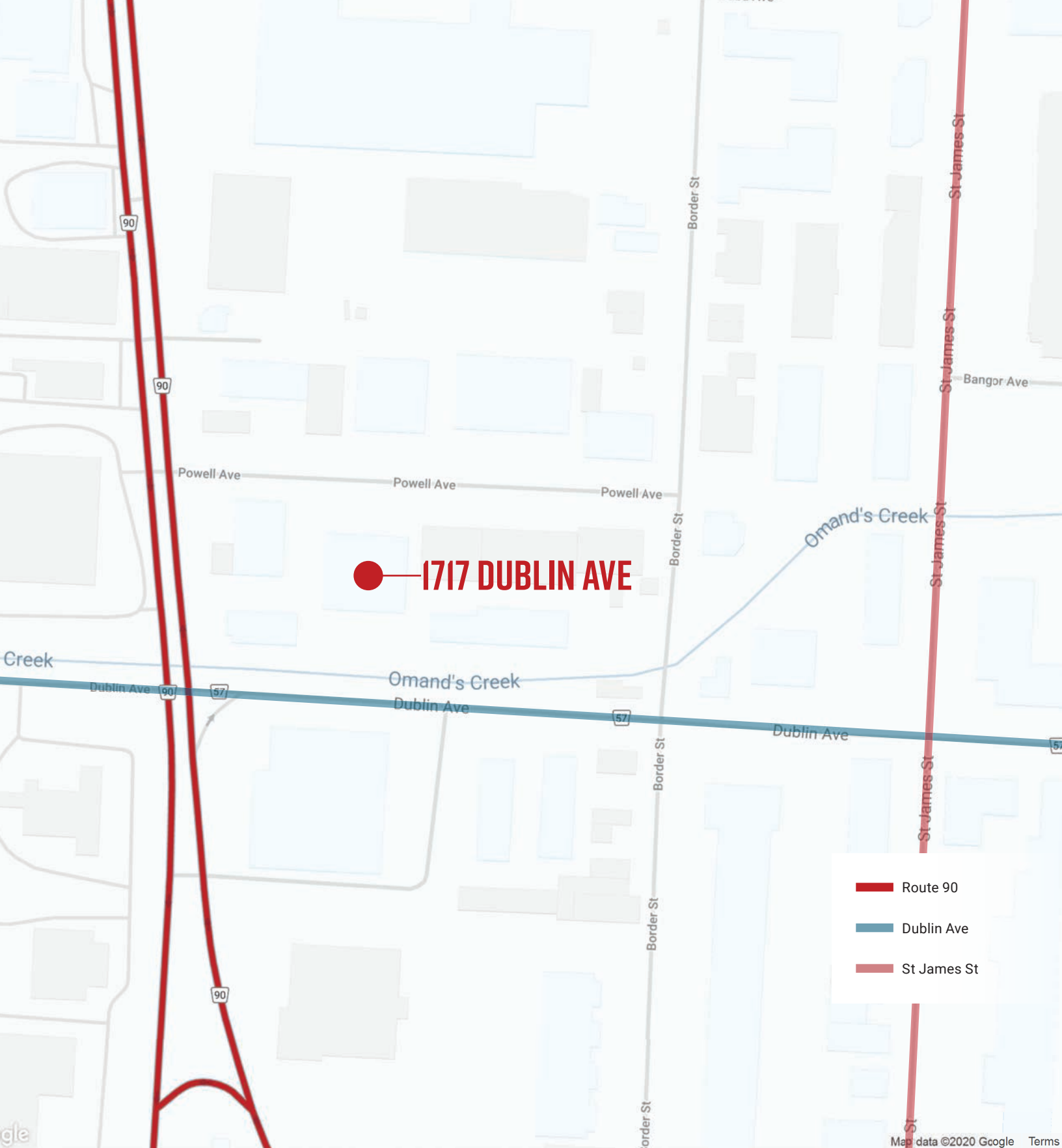

**BRAD GOERZEN**

Senior Vice President—Leasing—Central Region

(+1) 204-934-2797

bgoerzen@artisreit.com

**1717 DUBLIN AVENUE, WINNIPEG, MB**





**BRAD GOERZEN**

*Senior Vice President—Leasing—Central Region*

(+1) 204-934-2797

[bgoerzen@artisreit.com](mailto:bgoerzen@artisreit.com)

**1717 DUBLIN AVENUE, WINNIPEG, MB**

# 1717 DUBLIN AVE

WINNIPEG, MB

FOR LEASE: INDUSTRIAL



INDUSTRIAL LEASING

Cam Hildebrand  
204-934-2796

[www.artisreit.com](http://www.artisreit.com)

**BRAD GOERZEN**

Senior Vice President—Leasing—Central Region

(+1) 204-934-2797

[bgoerzen@artisreit.com](mailto:bgoerzen@artisreit.com)



**ARTIS**  
REIT